

GENERAL CATALOGUE



CAT-GEN-2010 (0)



FIRST IN MIDDLE EAST

QUALITY MAKE US THE BEST



INTRODUCTION.....	3
PRODUCT SPECIFICATIONS.....	3
<hr/>	
FAN COILS.....	4
FAN COIL CONDITIONERS	4
TOP DISCHARGE EXPOSED FLOOR MODELS	5
FRONT DISCHARGE FLOOR MODELS	6
CEILING MODELS	6
HIGH RISE FAN COIL UNIT	7
DUCTED FAN COILS	7
<hr/>	
AIR HANDLING UNITS.....	8
CENTERAL STATION MULTI-ZONE UNITS	9
<hr/>	
CONDENSERS.....	10
AIR COOLED CONDENSER	10
PACKAGED AIR -COOLED CONDENSING UNIT	10
<hr/>	
COILS.....	11
<hr/>	
PACKAGED UNITS.....	12
PACKAGED AIR CONDITIONING UNITS	12
AIRCOOLED PACKAGED UNITS	12
VERTICAL PACKAGED UNITS	13
HORIZONTAL COMPACT PACKAGED UNITS	14
HORIZONTAL PACKAGED UNITS	15
ROOF TOP PACKAGED UNIT	17
<hr/>	
CHILLERS SYSTEMS.....	18
AIR-Cooled Mini Chill	18
LIQUID CHILLER (RECIPROCATING COMPRESSOR.)	19
OPEN TYPE LIQUID CHILLER	23
AIR COOLED PACKAGED LIQUID CHILLER	25
SCROLL LIQUID CHILLER	26
<hr/>	
COOLING TOWER.....	27
<hr/>	
AIRFOIL FANS.....	28
AIRFOIL CENTRIFUGAL FAN	28
BACKWARD UTILITY FAN	29
<hr/>	
UTILITY FANS.....	30
BELT DRIVEN UTILITY FAN	30
<hr/>	
VENTILATORS.....	32
ROOF POWER VENTILATOR	32
<hr/>	
UNIT HEATER	33
HOT WATER UNIT HEATER	33
STEAM UNIT HEATER	34
ELECTRICAL UNIT HEATER	34
<hr/>	
INDUSTRIAL UNIT HEATER.....	35

TABLE OF CONTENTS

INTRODUCTION

SARAVEL Corp. was founded in 1960 as the first manufacturer of HVAC equipment in Iran. Relying on engineering expertise and technical know how, SARAVEL soon began the manufacturing of Chillers, Air Handling Units, Fan Coil Units, Cooling Towers, Packaged Units, Unit Heaters ,condenser ,condensing unit.

Today SARAVEL Corp. is the leading manufacturer of air conditioning equipment in the Middle East. Our product line includes standard equipment in addition to custom built units designed for use in a variety of applications such as oil and petrochemical Industries, plastic industries, ceramic industries, rolling mills, to name a few.

Design based on sound engineering principles, application of the latest international technical standards, and continuous dedication to quality improvement are goals and the driving force in the manufacture of SARAVEL products. For this reason, SARAVEL continuously improve the quality of products by focusing on the processes .in production lines and other areas.

The following is the SARAVEL General Catalog which outlines the ranges of capacities of the complete product line which SARAVEL has been offering for over 48 years. For more detailed information on specific products please contact SARAVEL Corp. Sales Office.

NOTE:

All specifications & dimensions subject to change without notice.

PRODUCT SPECIFICATIONS

Nominal capacities as listed are based on standard conditions. Ratings are expressed in English measurement for 50 Hz equipment.

Dimensions are always in terms of largest measurement for length, width, and height when looking from the front of the unit. (Dimensions are approximate, as all dimensions have been rounded upward to the next integer).

For more detailed information about all SARAVEL products, please contact SARAVEL Corp. Sales office. Or see our web site on www.saravel.com

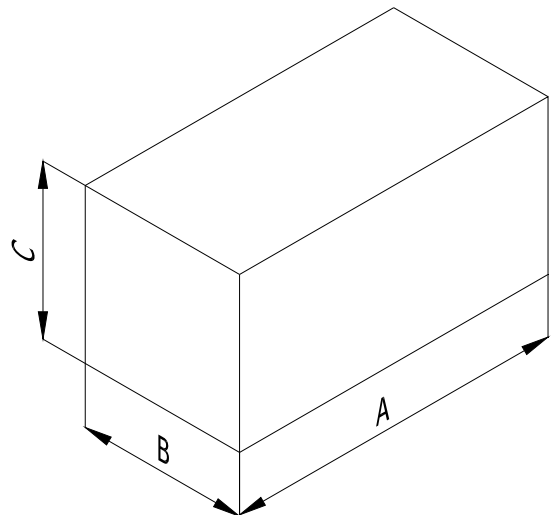



FAN COIL CONDITIONERS

APPLICATION

SARAVEL Fan coil units are intended for individually Controlled room air conditioning in buildings. Fan coils are used in hotels, office buildings and residential complexes, whereby a central plant supplies chilled and hot water for cooling and heating.

- 7 sizes in each model
- Heavy gage sheet metal, rugged construction
- Long life of critical items
- Quiet operation - whisper quiet on low speed
- Ease of installation and maintenance
- Decorative enclosures
- High performance

NOMINAL COOLING AND HEATING CAPACITY

Model	Air flow rate (CFM)	Water flow (gpm)		Cooling Cap. (Btu/hr)		Heating Cap. (Btu/hr)
		Cooling	Heating	Total	Sensible	
SF-02	200	1.6	2.1	7800	5300	20100
SF-03	300	2.5	3.1	12400	8300	30300
SF-04	400	3.2	4.1	16100	10800	39500
SF-06	600	4.4	5.8	21900	15000	56000
SF-08	800	6.0	7.7	30000	20300	74700
SF-10	1000	7.5	9.6	37500	25300	93500
SF-12	1200	9.5	11.8	47400	31600	114600

PHYSICAL DATA

Unit Size	SF-02	SF-03	SF-04	SF-06	SF-08	SF-10	SF-12
Face Area(sq.ft.)	0.9	1.4	1.6	1.9	2.4	3.1	3.8
Number Of Fans	1	2	2	2	3	4	4
Number Of Motors	1	1	1	1	2	2	2
Nominal Motors HP	1/30	1/25	1/20	1/20	1/20	1/20	1/20
Total Name Plate-Amps	0.2	0.24	0.24	0.3	0.5	0.6	0.6
High Medium Low	Approximate RPM						
	1000	1000	1000	1000	1000	1000	1000
	700	700	700	700	700	700	700

Note: Motor electrical characteristics are 220 V, 1 PH , 50 Cycles.

DIMENSIONS

Model	Weight (Kg)		Dimensions								
			A			B			C		
	HC	SE, HE	HC	HE, TB, SE	TB	SE	HC, HE	TB	SE	HC	HE
200	20	30	650	920	300	210	600	340	660	190	210
300	30	40	850	1120	300	210	600	340	660	190	210
400	30	40	950	1220	300	210	600	340	660	190	210
600	40	50	1090	1360	300	210	600	340	660	190	210
800	50	60	1350	1620	300	210	600	340	660	190	210
1000	60	70	1650	1920	300	210	600	340	660	190	210
1200	-	80	2000	2270	300	210	600	340	660	190	210

All dimensions are in mm.

Model	Weight (Kg)		Dimensions			
			A		B	C
	FC	FE, TE	FC	FE, TE		
200	30	30	650	920	210	600
300	30	40	850	1120	210	600
400	40	40	950	1220	210	600
600	40	50	1090	1360	210	600
800	50	60	1350	1620	210	600
1000	60	70	1650	1920	210	600
1200	80	80	2000	2270	210	600

All dimensions are in mm.

TOP DISCHARGE EXPOSED FLOOR MODELS

Model TE

The model TE is an exposed floor unit which is furnished in attractive decorative colors to match all interior decors. The one piece front panel is readily removable, allowing fast and complete access to the coil, fans, motor, speed control switch, electrical wiring, and fresh air damper. The fan deck slides out easily for maintenance. The filter can be removed and washed without having to remove the front panel.



(TE)

Model SE

This model has an inclined top cabinet, designed for applications in schools, institutions, hospitals and public buildings, where books and other objects are likely to be placed over the discharge grilles of a flat-top design. The slanted design precludes this possibility.



(SE)

Model TB .

The model TB "Lo-Boy" is a low silhouette top discharge exposed unit. The components and front panel arrangements are the same as the model TE. The basic unit and all features are the same as those of the exposed model TE.



FRONT DISCHARGE FLOOR MODELS

Model FE

The model FE is a front discharge exposed floor unit. All components and features are basically the same as model TE except for the discharge louver which is located in the front.

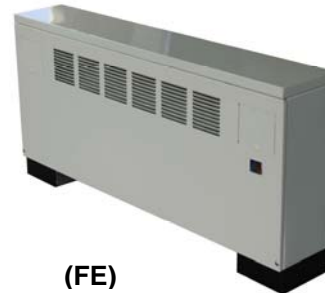

Model FC

The model FC (Front discharge Concealed floor unit) is a concealed unit with a decorative front panel supplied by the customer in accordance with his interior design needs. The model FC is designed specifically for furred in applications, an extension collar being used to connect the discharge duct of the basic unit to the decorative grille.

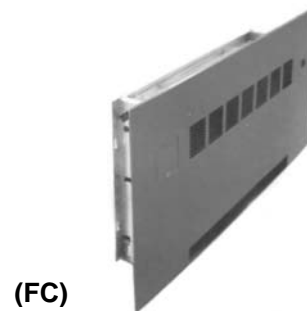

CEILING MODELS

CEILING MODELS ARE HORIZONTAL UNITS, AVAILABLE AS EXPOSED OR CONCEALED TYPES

Horizontal Model

Model HE

The model HE horizontal exposed unit is designed to be suspended from ceilings in new or existing buildings. All the components with the exception of the drain pan are the same as in the model TE. The model HE is furnished with an easily removable bottom panel which provides ready access to all the components for maintenance and service purposes.

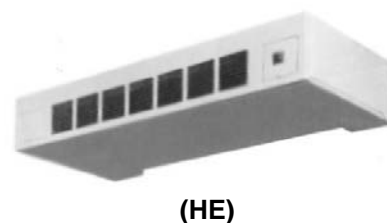

Horizontal Concealed Model

Model HC

The model HC horizontal concealed unit comes with a finished bottom access panel extending beyond the two side panels. The supply air outlet located in front of the unit provides a connection for ductwork which can supply the conditioned air to any number of diffuser configurations.





HIGH RISE FAN COIL UNIT

**Indoor air conditioners -800 to 1000 CFM
2 Models**

Special for high rise buildings when using one set of common risers for supply, return, and drain lines.

- Flexible and low cost installation and maintenance
- Uniform air circulation
- Two speed fan
- Heavy sheet metal rugged construction
- Small foot print area



DUCTED FANCOILS

**800 TO 2000 CFM
APPLICATIONS**

Apartments, office buildings hotels, and hospitals.

- 4 Different models and 7 basic sizes in each model
- Available in vertical or horizontal types
- Ease of installation & maintenance
- High cooling & heating capacities
- Available with DX coils
- Whisper quiet operation



EXPOSED MODEL

Model	Nominal (CFM)	Act. Cap. (MBH)		Weight (Kg)	Dimensions		
		Cooling	Heating		A	B	C
SD-08	800	25	68.5	70	650	900	430
SD-10	1000	30	85.6	70	750	900	430
SD-12	1200	40	102.8	100	950	900	430
SD-14	1400	50	120.1	100	950	900	430
SD-16	1600	60	137.3	100	1050	900	430
SD-18	1800	70	157.1	110	1200	900	430
SD-20	2000	80	176.8	120	1350	900	430



Cooling capacity at nominal CFM is based on 80 of DB & 67 of WB entering air and 40 of entering water temperature.
Heating capacity at nominal CFM is based on 60 of entering air and 180 of entering water and 20 of water temperature drop.
Nominal CFM is based on 0.5 inch of water external static pressure.

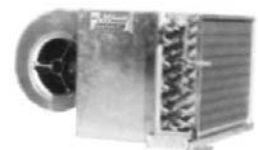

AIR HANDLING UNITS

15 Models

2000-8500CFM

Available as vertical and horizontal, in 15 standards models.(horizontal , vertical , L-type)
Flexibility to meet a wide range of cooling, heating, and ventilation requirements.

- Standard frame is constructed of aluminum channels with aluminum die cast corners (up to 4000 model).
- Frame with constructed with galvanized sheet metal connected with welding and bolts is available as request.
- Standard fans are designed with forward curved blades, (backward curved and airfoils are also available).
- Static pressure up to 8 in.w.g.
- All fan shafts are made of carbon steel.
- With chilled water, hot water, DX, and steam coils as required.
- Standard coils are designed with 3/8", 5/8" with plate fin And 3/4", 1/2", 1" with spiral fins.
- Spiral and plate fin materials include aluminum, copper, brass, carbon steel and stainless steel.
- Air washer, fog nozzle, sprayed coil, steam humidifier and spray nozzle are also available as humidification Options.
- Standard washable filters are installed in mixing box with 20% dust spot efficiency.
- Drain pan made of gal or steel sheet metal.
- High efficiency filters is also available as request.
- Flow control dampers constructed of aluminum opposed blade with class III tightness based on AMCA standards.
- Based chassis is constructed with heavy gage carbon sheet channels.



HORIZONTAL UNIT

Model	Cap.			Weight (Kg)	Dimensions		
	CFM	SP	(MBH)		A	B	C
250	2500	1/2 – 6	50	440	2230	1320	950
350	3500	1/2 – 6	80	540	2460	1400	1050
500	5000	1/2 – 6	120	600	2650	1580	1100
700	7000	1/2 – 8	180	720	2780	1750	1400
1000	10000	1/2 – 7	290	940	3030	2150	1400
1300	13000	1/2 – 8	370	1060	3130	2150	1700
1600	16000	1/2 – 8	470	1250	3320	2630	1700
2000	20000	1/2 – 8	620	1590	3660	2850	2000
2500	25000	1/2 – 8	650	1960	3660	3330	2020
3000	30000	1/2 – 8	820	2290	3520	3830	2020
3500	35000	1/2 – 8	980	2550	3620	4230	2170
4000	40000	1/2 – 8	1150	2950	3760	4530	2170
5000	50000	1/2 – 8	1450	3690	4110	4730	2600
6000	60000	1/2 – 8	1790	3900	4210	5200	2700
8000	80000	1/2 – 8	2450	5230	4500	5700	3250

Note: All dimensions are in mm.

Capacity is based on EDB 80F & EWB 67F.

CENTRAL STATION MULTI-ZONE UNITS

Capacity: 2000 to 85000 CFM

Available in 12 sizes to meet a wide range of cooling & heating & ventilation requirements. Triple-Deck Multizone is available to provide accurate interior zone temperature control.

- Standard frame is constructed of aluminum channels with aluminum die cast corners (up to 4000 model).
- Frame with constructed with galvanized sheet metal connected with welding and bolts is available as request.
- Standard fans are designed with forward curved blades, (backward curved and airfoils are also available).
- Static pressure up to 8 in.w.g. All fan shafts are made of carbon steel With chilled water, hot water, DX, and steam coils as required.
- Standard coils are designed with 3/8", 5/8" with plate fin And 3/4", 1/2", 1" with spiral fins.
- Spiral and plate fin materials include aluminum, copper, brass, carbon steel and stainless steel.
- Air washer, fog nozzle, sprayed coil, steam humidifier and spray nozzle are also available as humidification options.
- Standard washable filters are installed in mixing box with 20% dust spot efficiency.
- Drain pan made of gal or steel sheet metal. High efficiency filters is also available as request.
- Flow control dampers constructed of aluminum opposed blade with class III tightness based on AMCA standards.
- Based chassis is constructed with heavy gage carbon sheet channels.



Model	Fan (CFM)	Act. Cap. TC(MBH)	Weight (Kg)	Dimensions		
				A	B	C
MLZ-250	2500	50	440	2720	1100	1380
MLZ-350	3500	80	540	2950	1300	1500
MLZ-500	5000	120	600	3140	1420	1600
MLZ-700	7000	180	720	3270	1580	1960
MLZ-1000	10000	290	940	3520	1700	2000
MLZ-1300	13000	370	1060	3620	1900	2350
MLZ-1600	16000	470	1200	3810	2000	2400
MLZ-2000	20000	620	1590	4150	2100	2650
MLZ-2500	25000	650	1960	4150	2200	2750
MLZ-3000	30000	820	2290	4010	2200	2800
MLZ-3500	35500	980	2550	4110	2400	2950
MLZ-4000	39500	1150	2950	4250	2500	3000

AIR COOLED CONDENSER

Remote Air cooled condensers in 12 models.

Ideal for year round applications in multistory office buildings, hotels, schools and industrial facilities.

- All casings are constructed of heavy gage galvanized steel sheet panels
- Coils are designed and tested for 350 psig pressure.
- Choice of aluminum or copper fins
- Fan sequencing by condensing pressure.
- Epoxy paint
- Bly Gold coils as options.
- Stainless steel construction as option.
- Explosion resistance fan and blades as option.
- Centrifugal fans for low sound power level and indoor installations as option.
- The choice of the following schemes for low ambient temperatures ($T < 40$ OF) as option.
- Fan speed control with variable speed drive.

Model	Cap. (CFM)	Act. Cap. (MBH)	Weight (kg)	Dimensions		
				A	B	C
SAC-060	7200	62	159	1250	1400	1230
SAC-085	7800	92	207	1250	1800	1230
SAC-120	8100	129	274	1850	1800	1180
SAC-180	14400	192	634	2170	2000	1180
SAC-250	16800	267	838	2170	2500	1340
SAC-350	27000	353	872	2170	2500	1340
SAC-450	40500	504	1008	2170	3000	1340
SAC-550	41400	567	1174	2170	3500	1340
SAC-700	54000	706	1625	2x2170	2500	1340
SAC-850	58800	839	1940	2x2170	3000	1340
SAC-1000	90000	1072	2262	2x2170	3500	1340
SAC-1200	81000	1335	2490	2x2170	3500	1340



Note: All dimensions are in mm.

Capacity is based on Condensing Temp. 125F & Ambient Temp. 105F.

AIR -COOLED CONDENSING UNIT

Model	Act. Cap. (Kbtu/hr)	Comp Input (kw)	Weight (kg)	Dimensions		
				A	B	C
SCU210-1	120	9.6	1150	2000	2170	2000
SCU215-1	150	12.8	1250	2500	2170	2000
SCU215-2	160	14.2	1400	2500	2170	2000
SCU420-1	190	14.4	1450	2500	2170	2000
SCU420-2	230	19.4	1550	2500	2170	2000
SCU625-1	240	18.3	1550	3000	2170	2000
SCU630-1	280	22.5	1600	3000	2170	2000
SCU630-2	310	25.7	1750	3000	2170	2000
SCU640-1	390	35.1	1800	3500	2170	2000
SCU640-2	370	29.6	2000	3500	2170	2000
SCU850-1	480	41.1	2500	4780	2170	2000
SCU850-2	460	38.0	2600	4780	2170	2000
SCU860-1	580	49.4	2950	5780	2170	2000
SCU860-2	550	45.9	3100	5780	2170	2000
SCU1280-2	800	68.8	3550	6780	2170	2000
SCU-12100-2	960	82.8	3750	6780	2170	2000



Note: All dimensions are in mm.

Capacity is based on Evap. Temp. 45F & Ambient Temp. 105F.



CHILLED , HOT WATER , STEAM & DX COILS

SARAVEL Offers chilled water, hot water, DX, steam, & non-freeze steam coils in number of configurations which cover the entire range of air conditioning & industrial applications.

All coils are designed to meet ARI standard 410 and tested in accordance to ASHRAE standard 15-1992 (*Safety Code for Mechanical Refrigeration*).

Standard coils are designed with 5/8" or 3/8" copper tubes with possible alternate material selection. All tubes are mechanically expanded & bonded to aluminum or copper fins (spiral or plate fin) to provide 100% contact around the periphery.



FEATURES

- Maximum heat transfer & low air friction
- Available with plate fins or spiral fins
- Heavy gauge galvanized steel casings
- The working pressure is 250 psig.
- Steam coils are designed for operations up to 430 of saturated steam temperature.
- DX coils are fitted with a brass distributor with solder type connections.
- Standard connection stubs are threaded, flanged stubs are optional.
- Standard frame is made of galv. Steel. Stainless steel is also available.
- Hot and cold water furnished with air vent and drain connection.



CONSULT SARAVEL CORP. FACTORY FOR SPECIFIC COIL APPLICATIONS AND PERFORMANCE DATA.

PACKAGED AIR CONDITIONING UNITS

Compact packaged units intended for applications in new or existing stores, restaurants, offices, schools, computer rooms, airports and industrial plants.

5 to 120 Tons

- With air or water-cooled condensers
- Standard frame is constructed of aluminum channels with aluminum die cast corners.
- Frame with constructed with galvanized sheet metal connected with welding and bolts is available as request.

Hermetic and semi-hermetic compressors

- Units can be selected in rooftop, indoor, or split Packaged arrangements.

- With hot water, steam or electric heating coils
- Units can be in vertical or horizontal configuration.
- Copper tube, aluminum fin plate.

- R22 refrigerant as standard and all type of refrigerants as option.

- Copper tube, copper fin plate as option.
- Pressure actuated mechanical sequencer for fan motors shut-down, fan cycling as discharge pressure drops as option.

- For industrial process cooling and year round air conditioning, custom built units can also be designed and constructed as option.



AIRCOOLED PACKAGED UNITS

AIR COOLED

SPAR MODELS- 5 TO 120TONS

Model	Act. Cap.		Input power (Kw)	Weight (Kg)	Dimensions		
	Tons	CFM			A	B	C
SPAR-5-1	4.7	2000	4.2	570	2420	1430	1320
SPAR-8-1	7.3	3200	7.6	720	2750	1540	1540
SPAR-10-1	8.2	4000	10.1	870	3300	1760	1595
SPAR-15-1	10.8	6000	13.8	1100	3960	1980	1760
SPAR-20-1	13.7	8000	15.7	1170	4070	2420	1870
SPAR-25-1	17.0	10000	20.3	1490	4500	2420	1980
SPAR-30-1	20.1	12000	24.6	1550	4500	2420	2200
SPAR-35-1	24.4	14000	31.4	1900	5060	2970	2200
SPAR-40-1	29.2	16000	37.2	2000	5170	3080	2310
SPAR-10-2	9.0	4000	8.5	850	3300	1980	1650
SPAR-15-2	12.2	6000	15.0	1250	4070	2200	1870
SPAR-20-2	16.4	8000	20.2	1630	4500	2420	2035
SPAR-30-2	21.6	12000	27.4	1980	4950	2530	2200
SPAR-40-2	27.4	16000	31.3	2120	5170	2970	2310
SPAR-50-2	34.0	20000	40.5	2420	7150	3300	2420
SPAR-60-2	40.2	24000	49.4	2600	7260	3300	2750
SPAR-70-2	48.8	28000	63.1	3340	8470	3300	3300
SPAR-80-2	58.4	32000	74.4	4170	9570	3300	3575

Note: All dimensions are in mm.

Capacity is based on Face Velocity 500FPM & CT 125F for Air Cooled Packages.

(Length of packages based on fan coils, mixing box (with washable filter), compressor and condenser sections arrangement.)

VERTICAL PACKAGED UNITS

WATER COOLED

SHELL AND TUBE CONDENSER
SPWV MODELS – 5 TO 80 TONS

Model	Act. Cap.		Comp. Input (Kw)	Weight (Kg)	Dimensions		
	Tons	CFM			A	B	C
SPWV-5-1	4.8	2000	3.0	440	1320	880	1980
SPWV-8-1	7.9	3200	5.7	520	1540	880	2310
SPWV-10-1	9.4	4000	7.6	620	1760	990	2310
SPWV-15-1	12.6	6000	10.2	700	1980	990	2530
SPWV-20-1	15.8	8000	11.3	780	2420	1100	2530
SPWV-25-1	19.8	10000	14.8	850	2420	1100	2860
SPWV-30-1	23.4	12000	18.1	930	2420	1100	2970
SPWV-35-1	28.3	14000	22.9	1100	2970	1210	2970
SPWV-40-1	34.0	16000	27.2	1200	2970	1320	3080
SPWV-10-2	9.5	4000	6.0	670	2200	990	1640
SPWV-15-2	13.3	6000	11.4	920	2200	880	2860
SPWV-20-2	18.8	8000	15.2	1100	2460	1210	2970
SPWV-30-2	25.2	12000	20.3	1230	2640	1320	3300
SPWV-40-2	31.6	16000	22.6	1400	2970	1430	3300
SPWV-50-2	39.6	20000	29.5	1550	3300	1430	3520
SPWV-60-2	46.8	24000	36.3	1780	3300	1430	3630
SPWV-70-2	56.6	28000	45.9	2100	4400	1540	3630
SPWV-80-2	68.0	32000	54.4	2300	4400	1650	3630

Note: All dimensions are in mm.

Capacity is based on Face Velocity 500FPM & EWT 85F for Water Cooled Packages.



AIR COOLED

SPLIT TYPE- INDOOR SINGLE PACKAGE
SPAV MODELS- 5TO 80 TONS

Model	Act. Cap.		Comp. Input (Kw)	Weight (Kg)	Dimensions		
	Tons	CFM			A	B	C
SPAV-5-1	4.7	2000	4.2	340	1320	780	1980
SPAV-8-1	7.3	3200	7.6	420	1540	880	2310
SPAV-10-1	8.2	4000	10.1	490	1760	990	2310
SPAV-15-1	10.8	6000	13.8	560	1980	990	2530
SPAV-20-1	13.7	8000	15.7	630	2420	990	2530
SPAV-25-1	17.0	10000	20.3	670	2420	990	2860
SPAV-30-1	20.1	12000	24.6	750	2420	990	2970
SPAV-35-1	24.4	14000	31.4	870	2970	1100	2970
SPAV-40-1	29.2	16000	37.2	970	2970	1210	3080
SPAV-10-2	9.0	4000	8.5	470	1760	990	2310
SPAV-15-2	12.2	6000	15.0	700	2200	990	2860
SPAV-20-2	16.4	8000	20.2	830	2420	990	2750
SPAV-30-2	21.6	12000	27.4	950	2640	990	2970
SPAV-40-2	27.4	16000	31.3	1090	2970	1100	2970
SPAV-50-2	34.0	20000	40.5	1230	3300	1100	3190
SPAV-60-2	40.2	24000	49.4	1410	3300	1210	3520
SPAV-70-2	48.8	28000	63.1	1660	4400	1320	3520
SPAV-80-2	58.4	32000	74.4	1820	4400	1320	3740

Note: All dimensions are in mm.

Capacity is based on Face Velocity 500FPM & CT 125F for Air Cooled Packages.



HORIZONTAL COMPACT PACKAGED UNITS WATER COOLED

SHELL AND TUBE CONDENSER
SPWC MODELS - 5 TO 80 TONS

Model	Act. Cap.		Comp. Input (Kw)	Weight (Kg)	Dimensions		
	Tons	CFM			A	B	C
SPWC-5-1	4.8	2000	3.0	440	1540	1430	1320
SPWC-8-1	7.9	3200	5.7	520	1650	1540	1540
SPWC-10-1	9.4	4000	7.6	620	1650	1760	1600
SPWC-15-1	12.6	6000	10.2	700	1760	1980	1760
SPWC-20-1	15.8	8000	11.3	780	1980	2420	1870
SPWC-25-1	19.8	10000	14.8	850	2090	2420	2040
SPWC-30-1	23.4	12000	18.1	930	2310	2420	2200
SPWC-35-1	28.3	14000	22.9	1100	2310	2970	2200
SPWC-40-1	34.0	16000	27.2	1200	2200	3080	2310
SPWC-10-2	9.5	4000	6.0	670	1650	1760	1650
SPWC-15-2	13.3	6000	11.4	920	1760	2200	1870
SPWC-20-2	18.8	8000	15.2	1100	1870	2420	2040
SPWC-30-2	25.2	12000	20.3	1230	1980	2530	2200
SPWC-40-2	31.6	16000	22.6	1400	2090	2970	2310
SPWC-50-2	39.6	20000	29.5	1550	2090	3300	2420
SPWC-60-2	46.8	24000	36.3	1780	2310	3300	2750
SPWC-70-2	56.6	28000	45.9	2100	2530	3300	3300
SPWC-80-2	68.0	32000	54.4	2300	2420	3300	3580

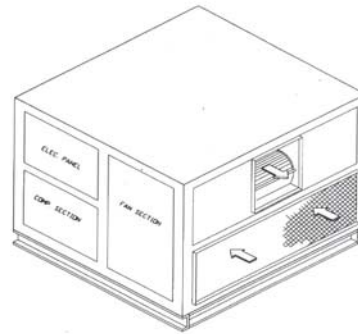

HORIZONTAL COMPACT UNIT
SINGLE FAN TYPE

Note: All dimensions are in mm.

Capacity is based on Face Velocity 500FPM & EWT 85F for Water Cooled Packages.

AIRCOOLED

SPLITTYPE- INDOOR SINGLE PACKAGE
SPAC MODELS (TYPE1) - 5 TO 80 TONS

Model	Act. Cap.		Comp. Input (Kw)	Weight (Kg)	Dimensions		
	Tons	CFM			A	B	C
SPAC-5-1	4.7	2000	4.2	340	1430	1430	1320
SPAC-8-1	7.3	3200	7.6	420	1430	1540	1540
SPAC-10-1	8.2	4000	10.1	490	1540	1760	1600
SPAC-15-1	10.8	6000	13.8	560	1540	1980	1760
SPAC-20-1	13.7	8000	15.7	630	1760	2420	1870
SPAC-25-1	17.0	10000	20.3	670	1870	2420	2040
SPAC-30-1	20.1	12000	24.6	750	1980	2420	2200
SPAC-35-1	24.4	14000	31.4	870	1980	2970	2200
SPAC-40-1	29.2	16000	37.2	970	1980	3080	2310
SPAC-10-2	9.0	4000	8.5	470	1430	1760	1750
SPAC-15-2	12.2	6000	15.0	700	1750	2200	1870
SPAC-20-2	16.4	8000	20.2	830	1760	2420	2040
SPAC-30-2	21.6	12000	27.4	950	1760	2530	2200
SPAC-40-2	27.4	16000	31.3	1090	1870	2970	2310
SPAC-50-2	34.0	20000	40.5	1230	1870	3300	2420
SPAC-60-2	40.2	24000	49.4	1410	2090	3300	2750
SPAC-70-2	48.8	28000	63.1	1660	2200	3300	3300
SPAC-80-2	58.4	32000	74.4	1820	2200	3300	3600



Note: All dimensions are in mm.

Capacity is based on Face Velocity 500FPM & CT 125F for Air Cooled Packages.

(Length of packages based on fan coils, mixing box (with washable filter), compressor and condenser sections arrangement.)



HORIZONTAL PACKAGED UNITS

WATER COOLED

SHELL AND TUBE CONDENSER

SPWH MODELS- 5 TO80 TONS

Model	Act. Cap.		Comp. Input (Kw)	Weight (Kg)	Dimensions		
	Tons	CFM			A	B	C
SPWH-5-1	4.8	2000	3.0	440	2420	1430	770
SPWH-8-1	7.9	3200	5.7	520	2530	1540	880
SPWH-10-1	9.4	4000	7.6	620	2640	1760	880
SPWH-15-1	12.6	6000	10.2	700	2750	1980	940
SPWH-20-1	15.8	8000	11.3	780	2750	2420	1045
SPWH-25-1	19.8	10000	14.8	850	3190	2640	1100
SPWH-30-1	23.4	12000	18.1	930	3190	2640	1210
SPWH-35-1	28.3	14000	22.9	1100	3300	2640	1320
SPWH-40-1	34.0	16000	27.2	1200	3300	2640	1540
SPWH-10-2	9.5	4000	6.0	670	2640	1760	990
SPWH-15-2	13.3	6000	11.4	920	2750	2200	1045
SPWH-20-2	18.8	8000	15.2	1100	2860	2420	1100
SPWH-30-2	25.2	12000	20.3	1230	2970	2640	1210
SPWH-40-2	31.6	16000	22.6	1400	3080	2640	1430
SPWH-50-2	39.6	20000	29.5	1550	3190	2640	1760
SPWH-60-2	46.8	24000	36.3	1780	3520	2640	2090
SPWH-70-2	56.6	28000	45.9	2100	3740	2640	2530
SPWH-80-2	68.0	32000	54.4	2300	3740	2640	2860

Note: All dimensions are in mm.

Capacity is based on Face Velocity 500FPM & EWT 85F for Water Cooled Packages.

AIR COOLED

SPLITTYPE- INDOOR SINGLE PACKAGED

SPAH MODELS (TYPE2) - 5 TO 80 TONS

Model	Act. Cap.		Comp. Input (Kw)	Weight (Kg)	Dimensions		
	Tons	CFM			A	B	C
SPAH-5-1	4.7	2000	4.2	340	2090	1430	770
SPAH-8-1	7.3	3200	7.6	420	2200	1540	880
SPAH-10-1	8.2	4000	10.1	490	2310	1760	880
SPAH-15-1	10.8	6000	13.8	560	2420	1980	940
SPAH-20-1	13.7	8000	15.7	630	2420	2420	1045
SPAH-25-1	17.0	10000	20.3	670	2860	2640	1100
SPAH-30-1	20.1	12000	24.6	750	2860	2640	1210
SPAH-35-1	24.4	14000	31.4	870	2860	2640	1320
SPAH-40-1	29.2	16000	37.2	970	2860	2640	1540
SPAH-10-2	9.0	4000	8.5	470	2310	1760	990
SPAH-15-2	12.2	6000	15.0	700	2420	2200	1045
SPAH-20-2	16.4	8000	20.2	830	2530	2420	1100
SPAH-30-2	21.6	12000	27.4	950	2640	2640	1210
SPAH-40-2	27.4	16000	31.3	1090	2750	2640	1430
SPAH-50-2	34.0	20000	40.5	1230	2860	2640	1760
SPAH-60-2	40.2	24000	49.4	1410	3190	2640	2090
SPAH-70-2	48.8	28000	63.1	1660	3300	2640	2530
SPAH-80-2	58.4	32000	74.4	1820	3300	2640	2860

Note: All dimensions are in mm.

Capacity is based on Face Velocity 500FPM & CT 125F for Air Cooled Packages.

(Length of packages based on fan coils, mixing box (with washable filter), compressor and condenser sections arrangement.)

ROOF TOP PACKAGED UNIT

3 to 10 tons Specification

Model	Nominal Cap.		Nominal Total power (Kw)	Weight (Kg)	Dimensions		
	Tons	CFM			A	B	C
SRTP-3	3	1000	4.6	170	1100	1000	830
SRTP-6	6	2100	5.8	280	1600	1400	830
SRTP-7.5	7.5	2800	6.9	350	1800	1550	830
SRTP-10	10	4100	11.4	550	2000	1500	1570

Note: All dimensions are in mm.



AIR-Cooled Mini Chill

- Suitable for Apartment , Office Buildings , hotels , ...
- High efficiency
- Lower energy consumption
- Remote control for on and off the system
- Quiet application.
- Compact system with small dimension
- Easy installation and maintenance
- Long life
- Eliminating cooling tower
- Equipped with water pump.
- Equipped with make up valve and adjust the inlet pressure



Model	Act. Cap. (Tons)	Comp. Input (Kw)	Weight (Kg)	Compressor Type	Power Supply	Evaporator Type
SACU-3-1	2.2	2.3	140(±10%)	Scroll Hermetic	230V / 1PH / 50Hz	Stainless-Steel Brazed Plate
SACU-6-2	4.8	4.7	200(±10%)	Scroll Hermetic	380V / 3PH / 50Hz	Stainless-Steel Brazed Plate

RECIPROCATING CHILLERS
Water-Cooled & Air-Cooled
One Compressor SLCH-10 to SLCH-80 Models

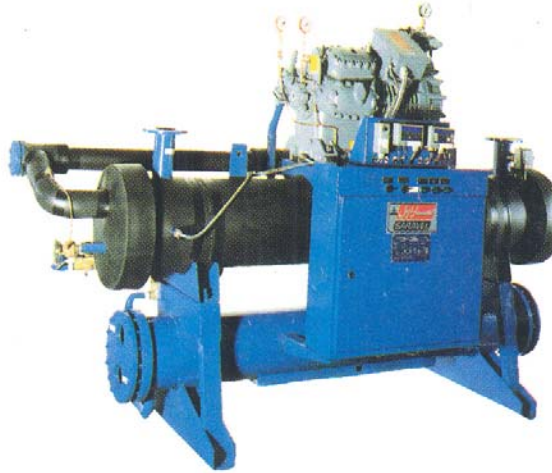

Model	Act. Cap. (Tons)	Comp. Input (Kw)	Weight (Kg)	Dimensions		
				A	B	C
SLCH-10-1W	9.4	8.8	560	2700	980	1390
SLCH-15-1W	12.6	11.5	660	2700	980	1430
SLCH-20-1W	15.8	12.3	770	2900	980	1440
SLCH-25-1W	19.8	16	810	3050	980	1470
SLCH-30-1W	23.4	19.3	940	2700	980	1500
SLCH-35-1W	28.3	24.6	1030	3550	980	1470
SLCH-40-1W	34.0	29.2	1500	3050	980	1590
SLCH-50-1W	41.3	33.1	1900	3600	1000	1650
SLCH-60-1W	49.2	41	2000	3600	1000	1650
SLCH-70-1W	55.5	42.9	2100	3600	1020	1850
SLCH-80-1W	64.5	51.1	2300	3600	1020	1850
SLCH-10-1A	8.2	9.7	430	2700	1000	1060
SLCH-15-1A	10.8	13.3	480	2700	1020	1100
SLCH-20-1A	13.7	14.7	580	2900	1020	1120
SLCH-25-1A	17.0	18.9	600	3050	1020	1120
SLCH-30-1A	20.1	22.7	700	2700	1020	1150
SLCH-35-1A	24.4	29	820	3550	1100	1110
SLCH-40-1A	29.2	34.5	1000	3050	1100	1200
SLCH-50-1A	36.6	39.2	1400	3600	1100	1300
SLCH-60-1A	42.1	48.4	1500	3600	1100	1300
SLCH-70-1A	47.0	49.5	1600	3600	1100	1500
SLCH-80-1A	55.7	59.3	1700	3600	1100	1500

Note: All dimensions are in mm.

RECIPROCATING CHILLERS
Water-Cooled & Air-Cooled
Two Compressor SLCH-20 to SLCH-160 Models



Model	Act. Cap. (Tons)	Comp. Input (Kw)	Weight (Kg)	Dimensions		
				A	B	C
SLCH-20-2W	18.8	17.8	1250	2400	1150	1410
SLCH-30-2W	25.2	21.2	1660	3250	1150	1420
SLCH-40-2W	31.6	26.3	1620	3050	1150	1480
SLCH-50-2W	39.6	31.9	1900	3550	1150	1500
SLCH-60-2W	46.9	38.7	2050	3550	1150	1500
SLCH-70-2W	56.7	49.2	2050	3550	1150	1530
SLCH-80-2W	68.1	58.4	2350	3550	1200	1640
SLCH-100-2W	82.6	66.2	2500	3600	1250	1710
SLCH-120-2W	98.4	82	2650	3600	1250	1760
SLCH-140-2W	111	85.7	3050	3950	1360	1960
SLCH-160-2W	129	102.1	3200	4150	1360	1960
SLCH-20-2A	16.4	23.8	1130	2900	1200	1120
SLCH-30-2A	21.6	27.9	1300	3250	1200	1120
SLCH-40-2A	24.7	30.6	1210	3050	1200	1170
SLCH-50-2A	34.1	37.7	1430	3550	1200	1190
SLCH-60-2A	40.2	45.4	1520	3550	1200	1190
SLCH-70-2A	48.8	58.1	1620	3550	1260	1250
SLCH-80-2A	58.3	69.0	1710	3550	1260	1300
SLCH-100-2A	73.2	78.4	1810	3600	1310	1390
SLCH-120-2A	84.2	96.8	1900	3600	1310	1450
SLCH-140-2A	94.1	99.0	2270	3950	1330	1580
SLCH-160-2A	111.4	118.7	2410	4150	1330	1580

Note: All dimensions are in mm.

RECIPROCATING CHILLERS
Water-Cooled & Air-Cooled
Three Compressor SLCH-30 to SLCH-240 Models.



MODEL SLCH-120-3W

Model	Act. Cap. (Tons)	Comp. Input (Kw)	Weight (Kg)	Dimensions		
				A	B	C
SLCH-60-3W	47.4	39.0	2370	3600	1250	1610
SLCH-75-3W	59.4	48.1	2450	3600	1250	1660
SLCH-90-3W	70.2	57.9	2550	3600	1250	1660
SLCH-105-3W	85	73.8	2600	3600	1250	1690
SLCH-120-3W	102.1	87.5	2850	3900	1250	1720
SLCH-150-3W	123.9	99.3	3250	4150	1350	1850
SLCH-180-3W	147.6	123	3610	4150	1350	1850
SLCH-210-3W	166.5	128.6	4360	4500	1520	2080
SLCH-240-3W	193.5	153.2	4850	4700	1520	2080
SLCH-60-3A	41.1	45.1	1700	3600	1260	1240
SLCH-75-3A	51.0	56.7	1780	3600	1260	1290
SLCH-90-3A	60.3	68.1	1870	3600	1260	1290
SLCH-105-3A	73.3	87.1	1900	3600	1260	1290
SLCH-120-3A	87.5	103.5	2300	3900	1260	1340
SLCH-150-3A	109.8	117.6	2570	4150	1350	1450
SLCH-180-3A	126.3	145.2	2900	4150	1540	1450
SLCH-210-3A	141.1	148.5	3420	4500	1590	1710
SLCH-240-3A	167.1	178	3710	4700	1590	1710

Note: All dimensions are in mm.

RECIPROCATING CHILLERS
Water-Cooled & Air-Cooled
Four Compressor SLCH-40 to SLCH-320 Models.



Model	Act. Cap. (Tons)	Comp. Input (Kw)	Weight (Kg)	Dimensions		
				A	B	C
SLCH-80-4W	63.2	61.1	3100	3650	1250	1660
SLCH-100-4W	79.2	74.2	3100	3650	1250	1660
SLCH-120-4W	93.8	86.3	3180	3950	1270	1660
SLCH-140-4W	113.3	98.4	3290	3950	1270	1720
SLCH-160-4W	136.1	116.7	3470	4150	1270	1770
SLCH-200-4W	165.2	132.4	4260	4500	1350	1940
SLCH-240-4W	196.8	164.0	4880	4700	1350	1940
SLCH-280-4W	222.0	171.4	5550	5750	1520	2240
SLCH-320-4W	258.0	204.2	6120	5750	1520	2240
SLCH-80-4A	54.8	66.2	2210	3650	1310	1290
SLCH-100-4A	68.2	75.7	2210	3650	1310	1290
SLCH-120-4A	80.4	99.6	2390	3950	1310	1290
SLCH-140-4A	97.7	116.2	2500	3950	1330	1330
SLCH-160-4A	116.0	138	2680	4150	1330	1380
SLCH-200-4A	146.4	156.8	3380	4500	1460	1560
SLCH-240-4A	168.4	193.6	4440	4700	1640	1560
SLCH-280-4A	188.1	198	4360	5750	1660	1800
SLCH-320-4A	222.3	237.4	4360	5750	1660	1800

Note: All dimensions are in mm.

RECIPROCATING OPEN TYPE COMPRESSOR

APPLICATIONS

Industrial: Plastic, Food, and Petrochemical industries.
Comfort: Office buildings, Apartments, Hotels, Schools, and Stadiums.

- Independent electrical circuits for multi compressors
- Low start and running current because of sequential starting and stopping of compressors
- Ease of maintenance
- Optimum chilled water temperature control
- Choice of water or air cooled condensers
- Factory assembled package for quick and low cost installation and peak performance
- Capacity control for energy efficiency



MODEL SLCO-180-2W

RECIPROCATING CHILLERS

Water-Cooled and Air-Cooled

SLCO-50-1 to SLCO-150-1 Models
 50 to 150 Tons

Model	Act. Cap. (Tons)		Comp. Input (Kw)		Weight (Kg)		Dimensions			
	water	air	water	air	water	Air	A	B		C
								water	air	
SLCO-50-1	47	39.7	33.1	37.4	2350	2020	2850	990	930	1550
SLCO-75-1	62.8	53	44.9	50.7	2550	2190	3300	990	930	1550
SLCO-90-1	78.5	66.3	55.6	62.8	3000	2590	3300	1070	930	1600
SLCO-100-1	94.2	79.5	66	74.6	3150	2720	3600	1070	930	1600
SLCO-120-1	109.9	92.7	76.3	86.1	3550	3000	3600	1170	930	1600
SLCO-150-1	125.6	105.9	86.3	97.4	3850	3200	3600	1170	930	1600

Note: All dimensions are in mm.

RECIPROCATING CHILLERS

Water-Cooled and Air-Cooled

SLCO-180-2 to SLCO-300-2 Models
 180to 300 Tons

Model	Act. Cap. (Tons)		Comp. Input (Kw)		Weight (Kg)		Dimensions		
	water	air	water	air	water	Air	A	B	C
SLCO-180-2	157	132.6	111.2	125.6	5550	4750	3650	1730	1720
SLCO-200-2	188.4	159	132	149.2	5880	5000	3950	1730	1740
SLCO-240-2	219.8	185.4	152.6	172.2	6650	5550	3950	1730	1790
SLCO-300-2	251.2	211.8	172.6	194.9	7280	6000	3950	1730	1810

Note: All dimensions are in mm.

Capacity is based on Condenser leaving water 95F & Cooler leaving water 45F for Water cooled .
 Capacity is based on Condensing leaving water 125F & Cooler leaving water 45F for air cooled.

RECIPROCATING CHILLERS
Water-Cooled and Air-Cooled
 SLCO-360-4 to SLCO-600-4 Models
 360 to 600 Tons



MODEL SLCO-360-4W

Model	Act. Cap. (Tons)		Comp. Input (Kw)		Weight (Kg)		Dimensions			
	water	air	water	air	water	Air	A	B		C
								water	air	
SLCO-360-4	314	265.2	222.3	251.3	9700	8100	4650	1860	1900	1810
SLCO-400-4	376.8	318	264.1	298.4	10900	8800	5650	1860	1900	1830
SLCO-480-4	439.6	370.8	305.3	344.4	12600	10200	5650	2040	1900	1910
SLCO-600-4	502.4	423.6	345.2	389.7	13400	10900	6150	2160	1900	1910

Note: All dimensions are in mm.

CHILLERS 950 SERIES

Low speed open type compressor
8 Models -180 to 720 Tons

- Suitable for air conditioning as well as many other industrial and commercial liquid chilling systems.
- Equipped with heavy duty reciprocating multi-cylinder open type compressor which runs at 950 RPM.
- Ideal for hospitals and hotels where low noise levels are of paramount importance.
- Long-life of critical items due to lower wear rates of the motor-compressor.
- Safety controls include high and low pressure cutouts, oil pressure safety cut-out, motor overload protection, flow switch and anti-freeze control.



MODEL SLCO-250-1W

Model	Act. Cap. (Tons)	Comp. Input (Kw)	Weight (Kg)	Dimensions		
				A	B	C
SLCO-175-1W	171.1	113.3	8500	4750	1500	2310
SLCO-250-1W	229.0	150.5	9000	4800	1500	2370
SLCO-300-1W	215.3	160.6	8950	4800	1500	2370
SLCO-335-1W	287.4	214.5	9500	4800	1500	2385
SLCO-350-2W	343.4	226.6	16500	4800	2750	2450
SLCO-500-2W	458.0	301.1	18000	4820	2750	2600
SLCO-600-2W	430.6	321.2	17500	4820	2750	2550
SLCO-700-2W	574.8	429.0	19000	4820	2750	2600

Note: All dimensions are in mm.

Capacity is based on Condenser leaving water 95F & Cooler leaving water 45F for Water cooled.



AIR COOLED PACKAGED LIQUID CHILLER

SARAVEL Air cooled packaged liquid chillers are completely self-contained and designed for outdoor (roof or ground level) installations in new or existing stores, restaurants, offices, schools, computer rooms, and industrial plants. The low profile and ease of installation associated with these units makes it possible that the only alteration in existing buildings is the chilled water supply and return piping to central station air handling or terminal units.



- Available in 16 different models with cooling capacities ranging from 10 to 320 tons
- Heavy gage, galvanized steel structure
- Rigid structural steel base frame
- Copper fin plate for corrosive environments
- Condenser fan and compressor sequencing via multistage thermostat Water.
- Evaporator could be shell and tube or plate type.

Model	Act. Cap. (Tons)	Comp. Input (Kw)	Evaporator (GPM)	Weight (Kg)	Dimensions		
					A	B	C
SPLCH-10-1	8.9	9.0	21	1700	2500	2170	2000
SPLCH-15-1	11.7	12.2	28	1750	2500	2170	2000
SPLCH-15-2	12.4	13.7	30	1900	2500	2170	2000
SPLCH-20-1	14.3	14.0	34	1950	2500	2170	2000
SPLCH-20-2	17.0	18.7	41	2150	2500	2170	2000
SPLCH-25-1	18.0	17.8	43	2100	3000	2170	2000
SPLCH-30-1	21.1	21.7	51	2300	3000	2170	2000
SPLCH-30-2	23.0	24.8	55	2450	3000	2170	2000
SPLCH-40-1	29.7	33.8	71	2500	3500	2170	2000
SPLCH-40-2	28.2	28.5	68	2650	3500	2170	2000
SPLCH-50-1	36.6	39.7	88	3300	4780	2170	2000
SPLCH-50-2	35.2	36.6	85	3400	4780	2170	2000
SPLCH-60-1	43.8	47.6	105	3750	5780	2170	2000
SPLCH-60-2	41.5	44.0	100	3900	5780	2170	2000
SPLCH-80-2	60.6	66.3	146	4550	6780	2170	2000
SPLCH-100-2	72.9	79.8	175	4800	6780	2170	2000

Note: All dimensions are in mm.

AIR COOLED SPLIT LIQUID CHILLER (NEW)



SCROLL LIQUID CHILLER

10 TO 100 TONS

- Scroll compressor.
- Braze plate evaporator.
- Shell and tube condenser.
- Copper refrigerant tubing.
- R22 refrigerant.
- Compact electric panel with PLC controller.
- 4 stage electronic thermostat.
- High and low pressure control.
- Emergency switch.
- Flow switch.
- Water strainer.
- Anti freeze protection.
- Filter drier.
- Thermal expansion valve.
- Charging and service valve.



Model	Act. Cap. (Tons)	Comp. Input (Kw)	Evaporator (GPM)	Weight (Kg)	Dimensions		
					A	B	C
SLCS-10-2-W	8.6	6.5	21	550	2300	700	1410
SLCS-15-2-W	12.3	9.7	30	570	2300	700	1410
SLCS-20-2-W	17.3	13.3	42	600	2300	700	1410
SLCS-25-2-W	21.4	16.7	51	650	2300	700	1410
SLCS-30-4-W	24.7	19.4	59	1150	2400	950	1410
SLCS-40-4-W	34.7	26.6	83	1200	2400	950	1410
SLCS-50-4-W	42.8	33.4	103	1250	2400	950	1410
SLCS-60-4-W	50.8	40.0	122	1300	2400	950	1410
SLCS-80-4-W	66.7	52.0	160	1700	2575	1100	1500
SLCS-100-4-W	82.3	62.2	197	1850	2575	1100	1500

Note: All dimensions are in mm.

Capacity is based on Condenser leaving water 95F & Cooler leaving water 45F for Water cooled .



COOLING TOWER

10 TO 1140 TONS

APPLICATIONS

INDUSTRIAL AND AIR CONDITIONING

- Heat transfer surface in SARAVEL cooling towers are splash type, Non-Clogging fills fabricated of polypropylene.
- P.P drift eliminators are honeycomb flute, UV-resistant durable against deformation under direct sun Light.

or

- Heavy Gage Galvanized Drift Eliminators.
- Non-Clogging spray nozzles are designed to break and distribute the water flow in an umbrella type are fabricate of polypropylene .
- Heavy galvanized sheet metal for basin
- Centrifugal fans that are statically and dynamically balanced, mounted in a housing.

- Final epoxy coating.

FEATURES

- High performance, Non-Clogging with low operating cost
- Wide range of capacities
- Whisper quiet operation
- Low water pressure drop
- Maximum corrosion protection



Model	Air Flow (CFM)	GPM	Weight (Kg)	Dimensions		
				A	B	C
SCT-10-1-1	2255	30	352	1530	550	1900
SCT-15-1-1	3384	45	440	1680	720	1900
SCT-20-1-1	4511	60	530	1730	930	1960
SCT-25-1-1	5640	75	650	2130	930	1960
SCT-30-1-1	6769	90	780	2360	930	2000
SCT-35-1-1	7895	105	900	2700	930	2000
SCT-40-1-1	9024	120	980	2900	930	2000
SCT-50-1-1	11281	150	1170	2900	1200	2000
SCT-60-1-1	13538	180	1590	2900	1450	2750
SCT-75-1-2	16921	230	2310	2900	1750	2750
SCT-90-1-2	20306	270	2390	2900	1930	2750
SCT-105-1-2	23684	320	2740	2900	2400	2750
SCT-120-1-3	27073	360	3490	2900	2900	2750
SCT-140-1-3	31578	420	3840	2900	3350	2750
SCT-160-1-4	36097	480	4680	2900	3900	2750
SCT-180-1-4	40612	540	4950	2900	4200	2750
SCT-220-1-5	49637	660	5780	2900	4900	2750
SCT-260-1-6	58632	780	6780	2900	5800	2750
SCT-300-1-7	67676	900	7980	2900	6800	2750
SCT-340-1-8	67710	1020	9070	2900	7800	2750
SCT-340-2-4	67710	1020	8870	4750	3900	2750
SCT-400-2-5	90211	1200	10770	4750	4900	2750
SCT-450-2-6	101531	1350	12890	4750	5700	2750
SCT-500-2-6	112814	1500	13170	4750	5850	2750
SCT-580-2-7	130833	1740	15170	4750	6800	2750
SCT-660-2-8	148905	1980	17450	4750	7800	2750
SCT-740-2-9	166963	2220	19550	4750	8710	2750
SCT-820-2-10	185014	2460	21740	4750	9710	2750
SCT-900-2-11	202951	2700	23640	4750	10700	2750
SCT-980-2-12	221020	2940	25730	4750	11650	2750
SCT-1060-2-13	239086	3180	27830	4750	12610	2750
SCT-1140-2-14	257149	3420	29820	4750	13600	2750

Note: All dimensions are in mm.

COOLING TOWER

AIRFOIL CENTRIFUGAL FANS

SARAVEL Air foils are intended for industrial process ventilation, with capacities ranging from 700 CFM to 364550 CFM with static pressures up to 23 inch w.g.

- Available in single width or double width
- Available in 16 different standard rotation and discharge configurations
- Available in 2 different standard drive arrangements
- Choice of direct drive or belt driven
- Rigid, heavy gage sheet metal fan housing
- Heavy duty pillow block bearings
- Air foils are statically and dynamically balanced

CUSTOM BUILT UNITS

Custom built units can be designed and fabricated for special applications. One such unit is illustrated on the right.

SARAVEL Single inlet, down blast-discharge air foil, custom designed to deliver 56000 CFM against 11" total static pressure, used in wood and paper industries.



BACKWARD UTILITY FAN

STANDARD UNITS - SINGLE WIDTH

Size	CFM	SP (in.w.g)	Dimensions		
			A	B	C
SWSI-122	1200-3000	1/4-11	580	590	690
SWSI-135	1500-4000	1/4-11	630	610	750
SWSI-150	1800-5000	1/4-11	700	680	840
SWSI-165	2200-6000	1/4-11	750	710	920
SWSI-182	2500-7000	1/4-12	840	790	1020
SWSI-200	3000-8000	1/4-12	920	840	1120
SWSI-222	4000-9500	1/4-13	1020	940	1240
SWSI-245	5000-11000	1/4-13	1110	990	1370
SWSI-270	7500-17000	1/4-15	1230	1100	1510
SWSI-300	9000-20000	1/4-15	1340	1200	1660
SWSI-330	10000-23000	1/4-15	1470	1280	1820
SWSI-365	13000-25000	1/4-15	1590	1420	1820
SWSI-402	18000-30000	1/4-15	1770	1570	1990
SWSI-445	21000-37000	1/4-15	1940	1730	2160
SWSI-490	25000-45000	1/4-15	2140	1890	2360
SWSI-542	30000-55000	1/4-15	2380	2060	1650
SWSI-600	40000-75000	1/4-19	2630	2290	2900
SWSI-660	45000-100000	1/4-23	2880	2510	3200
SWSI-730	50000-130000	1/4-23	3210	2730	3550
SWSI-807	50000-150000	1/4-23	3540	3020	3900

Note: All dimensions are in mm.

STANDARD UNITS – DOUBLE WIDTH

Size	CFM	SP (in.w.g)	Dimensions		
			A	B	C
DWDI-122	2400-6000	1/4-11	580	590	690
DWDI -135	3000-7500	1/4-11	630	650	750
DWDI -150	3500-9000	1/4-11	700	700	840
DWDI -165	4500-11000	1/4-11	750	750	920
DWDI -182	5000-13000	1/4-12	840	830	1020
DWDI -200	6000-16000	1/4-12	920	890	1120
DWDI -222	8000-18000	1/4-13	1020	970	1240
DWDI -245	10000-21000	1/4-13	1110	1050	1370
DWDI -270	13000-28000	1/4-15	1230	1160	1510
DWDI -300	15000-35000	1/4-15	1340	1260	1660
DWDI -330	20000-42000	1/4-15	1470	1370	1820
DWDI -365	25000-50000	1/4-15	1590	1550	1820
DWDI -402	35000-65000	1/4-15	1770	1680	1990
DWDI -445	40000-75000	1/4-15	1940	1830	2160
DWDI -490	50000-90000	1/4-15	2140	1980	2360
DWDI -542	60000-110000	1/4-15	2380	2160	1650
DWDI -600	80000-150000	1/4-19	2630	2330	2900
DWDI -660	90000-200000	1/4-23	2880	2540	3200
DWDI -730	100000-250000	1/4-23	3210	2780	3550
DWDI -807	100000-300000	1/4-23	3540	3050	3900



SW-SI FORWARD UTILITY FAN

APPLICATIONS

Air conditioning units, Heating & ventilating units, Exhaust systems

- Wheels are balanced statically & dynamically.
- Fabricated from heavy gage sheet met
- Three designs:

Design 1: This is the standard wheel. Suitable for tip Speeds up to 6000 ft/min (approx. 4 1/2" sp)

Design 2: Peripherally reinforced for tip speeds up to 7000 ft/min (approx. 6" sp)

Design 3: Additionally reinforced for tip speeds up to 8100 ft/min (approx. 8" sp)



Fan size	Cap. (CFM)	SP (in.w.g)	Weight (Kg)	Dimension		
				A	B	C
SWSI-9	450-1800	1/2-8	40	600	400	470
SWSI-11	750-2200	1/2-8	50	640	400	580
SWSI-13	850-2700	1/2-8	60	690	520	610
SWSI-14	1500-4200	1/2-8	70	790	580	710
SWSI-16	1800-4500	1/2-8	75	840	640	740
SWSI-17	2000-5000	1/2-8	80	910	680	790
SWSI-19	2500-7000	1/2-7	100	980	740	890
SWSI-22	3500-9000	1/2-7	130	1130	850	980
SWSI-26	4200-12000	1/2-7	200	1190	1040	1190
SWSI-29	5500-15000	1/2-7	320	1300	1160	1350
SWSI-32	6200-20000	1/2-8	370	1350	1280	1470

Note: All dimensions are in mm.
 THD: Top Horizontal Discharge
 BHD: Bottom Horizontal Discharge
 UBD: Up Blast Discharge

DW-DI FORWARD UTILITY FAN

APPLICATIONS

Air conditioning units, Heating & ventilating units, Exhaust systems

- Wheels are balanced statically & dynamically.
- Fabricated from heavy gage sheet met
- Three designs:

Design 1: This is the standard wheel. Suitable for tip speeds up to 6000 ft/min (approx. 4 1/2" sp)

Design 2: Peripherally reinforced for tip speeds up to 7000 ft/min (approx. 6" sp)

Design 3: Additionally reinforced for tip speeds up to 8100 ft/min (approx. 8" sp)



Fan size	Cap. (CFM)	SP (in.w.g)	Weight (Kg)	Dimension		
				A	B	C
DWDI-9	900-3600	1/2-8	50	710	375	495
DWDI-11	1500-4400	1/2-8	60	770	420	560
DWDI-13	1700-5400	1/2-8	75	940	425	650
DWDI-14	3000-8400	1/2-8	85	1000	510	720
DWDI-16	3600-9000	1/2-8	95	1055	545	788
DWDI-17	4000-10000	1/2-8	100	1115	580	858
DWDI-19	5000-14000	1/2-7	125	1180	630	926
DWDI-22	7000-18000	1/2-7	165	1350	725	1064
DWDI-26	8400-24000	1/2-7	250	1560	940	1264
DWDI-29	11000-30000	1/2-7	400	1715	1043	1410
DWDI-32	12400-40000	1/2-8	465	1840	1147	1550

Note: All dimensions are in mm.
 THD: Top Horizontal Discharge
 BHD: Bottom Horizontal Discharge
 UBD: Up Blast Discharge

ROOF POWER VENTILATOR

350-5300 CFM

- For use in exhausting air from buildings
- Galvanized steel construction
- direct driven fan
- Self acting or motor operated damper (optional)



Model	Cap. (CFM)	Weight (Kg)	Dimensions		
			A	B	C
SRP-98	240-500	40	550	460	510
SRP-108	330-620	40	570	480	520
SRP-122	340-800	40	590	500	530
SRP-135	540-1100	50	610	520	540
SRP-150	630-1600	50	660	570	550
SRP-165	990-2000	60	710	620	560
SRP-182	880-2800	80	760	670	670
SRP-200	1270-3900	90	810	720	680
SRP-222	1650-5500	110	860	770	730
SRP-245	2100-4600	120	910	820	750

Note: All dimensions are in mm.



Classic Models

Hot water, Steam & Electrical UNIT HEATER

200 to 3500 CFM

- SARAVEL Unit Heaters may be selected for hot water or steam or hot oil applications from 12 different models in two categories, namely: 1) Standard 2) High Capacity.
- Standard capacity features 3/8" copper coils but High capacity features 1/2" steel coil. For various range of required airflow, 900 RPM or 1400 RPM motors can be mounted on units. With these features Saravel unit heaters covers the entire range of commercial, industrial and institutional applications with a wide choice of capacities which permit tremendous versatility in design and engineering application.
- Units are designed for 10 to 240 kBtu/hr capacity for hot water applications and 20 to 540 kBtu/hr for steam applications.
- Units are designed for optimum air throw through individually adjustable louvers to permit altering the direction of air flow. The provisions for lifting and hoisting the units also serve as installation features. The unit casing can be easily dismantled allowing access to the coil for cleaning purpose.

Hot water

900 RPM

Model	Cap. (MBH)	CFM	Weight (Kg)	Dimensions		
				A	B	C
10H	10.3	230	30	560	540	620
12H	19.9	460	40	640	540	700
14H	32.1	750	50	720	540	780
16H	45.7	1100	60	790	540	850
18H	75.8	1800	70	930	540	990
20H	98.7	2300	80	1030	540	1090

Note: All dimensions are in mm.



UNIT HEATER

1400 RPM

Model	Cap. (MBH)	CFM	Weight (Kg)	Dimensions		
				A	B	C
10H	13.9	370	30	560	540	620
12H	26.7	730	40	640	540	700
14H	43.1	1200	50	720	540	780
16H	60.1	1700	60	790	540	850
18H	102	2900	70	930	540	990
20H	129	3500	80	1030	540	1090

Note: All dimensions are in mm.

STEAM

900 RPM

Model	Cap. (MBH)	CFM	Weight (Kg)	Dimensions		
				A	B	C
10H	21.8	230	30	560	540	620
12H	43.2	460	40	640	540	700
14H	67.5	750	50	720	540	780
16H	94.0	1100	60	790	540	850
18H	156	1800	70	930	540	990
20H	201	2300	80	1030	540	1090

Note: All dimensions are in mm.

1400 RPM

Model	Cap. (MBH)	CFM	Weight (Kg)	Dimensions		
				A	B	C
10H	28.9	370	30	560	540	620
12H	56.6	730	40	640	540	700
14H	88.4	1200	50	720	540	780
16H	120	1700	60	790	540	850
18H	205	2900	70	930	540	990
20H	256	3500	80	1030	540	1090

Note: All dimensions are in mm.

Electrical

900 RPM

Model	Cap. (Kw)	CFM	Weight (Kg)	Dimensions		
				A	B	C
10H	1.5	230	30	560	540	620
12H	2.9	460	40	640	540	700
14H	4.7	750	50	720	540	780
16H	7.0	1100	60	790	540	850
18H	11.4	1800	70	930	540	990
20H	14.6	2300	80	1030	540	1090

Note: All dimensions are in mm.

1400 RPM

Model	Cap. (Kw)	CFM	Weight (Kg)	Dimensions		
				A	B	C
10H	2.3	370	30	560	540	620
12H	4.6	730	40	640	540	700
14H	7.6	1200	50	720	540	780
16H	10.8	1700	60	790	540	850
18H	18.4	2900	70	930	540	990
20H	22.2	3500	80	1030	540	1090

Note: All dimensions are in mm.



INDUSTRIAL UNIT HEATER

Industrial unit heaters are utilized where heating capacities and space volumes are large. Horizontal discharge or down blast discharge units may be used, depending on the requirement.

APPLICATION

Machine shops, ware house shipping rooms, factories, foundries and processing plants.

- Capacities range from 2000 to 42000 CFM
- Horizontal units (horizontal discharge) are recommended for areas having low ceilings.
- Vertical units (down blast discharge) are intended for buildings with high ceilings.
- Available with hot water or steam coils



INDUSTRIAL STEAM UNIT HEATER

Model	Cap. (BTU/hr)	CFM	Dimensions		
			A	B	C
1B13S	146900-341500	2600	1150	600	2600
2B11S	203000-481900	3650	1400	650	2600
2B13S	282400-651800	4850	1600	750	2600
2B14S	374200-818300	6700	1850	750	2750
2B17S	492900-1187700	9400	2200	850	2950
2B19S	719600-1801900	14000	2400	1100	3650
3B19S	1045700-2528300	20200	3250	1100	3650
4B19S	1733400-4036000	31200	4100	1450	3650

Note: All dimensions are in mm.

INDUSTRIAL HOT WATER UNIT HEATER

Model	Cap. (BTU/hr)	CFM	Dimensions		
			A	B	C
1B13S	117100-231800	2600	1150	600	2600
2B11S	168000-337300	3650	1400	650	2600
2B13S	237300-458800	4850	1600	750	2600
2B14S	329000-589400	6700	1850	750	2750
2B17S	437500-878000	9400	2200	850	2950
2B19S	640000-1344400	14000	2400	1100	3650
3B19S	959400-1917200	20200	3250	1100	3650
4B19S	1594800-3042600	31200	4100	1450	3650

Note: All dimensions are in mm.



SARAVEL CORP.

Jan. 2010

Manufacturer reserves the right to make changes in design and construction, without notice.

(Head Office)

No. 43, North Sheikh Bahai Avenue, Tehran 19917 , IRAN

Tel: (+98-21) 88046921 (6 lines) Fax: (+98-21) 88046920

E-Mail: sales@saravel.com

Site: <http://www.Saravel.com>